

9) LAYOUT-SPARE PARTS LIST

Ed. 06/17

POLYCHEM PART NO.	ITEM	DESCRIPTION	QTY		
190020	A000007	LT TENSION MOTOR GROUP	1		*
X	A000038	WELDING MOTOR ASSEMBLY	1		*
B400BAT	A000063	BATTERY 2A/h 14.8V	1	§	*
190025	A000097	SIGNAL CARD	1		*
190026	B400186	BEARING 61808-RS1	2		
190027	B400187	ROLLER BEARING 5X8X8	4		
190028	B400188	FREEWHEEL INA HF0812	1		
190029	B400332	BEARING 609 ZZ SKF	1		
190030	B400333	BEARING 61902 ZZ	2		
190031	B500035	SCREW M4X10	12		
190032	B500036	SCREW M5X12	5		
190161	B500068	SCREW M3X8 UNI 5931	1		
190036	B500140	SCREW M5X30	1		
190037	B500158	SCREW M4X12	3		
190038	B500208	SCREW BN13577 3,5X20 KA35	4		
190147	B500211	LOCK. WASHER	6		
190039	B500214	SCREW M4X8	2		
190040	B500273	SCREW M3X10	6		
190041	B500275	SCREW M2X10	2		
190042	B500281	SELFLOCK. NUT M6 D985 5S	1		
190043	B500336	SCREW M4X10	1		
190044	B500379	SCREW M4X5	5		
190045	B500384	SCREW 2.9X4.5	2		
190046	B500385	SCREW 2.9X6.5	3		
190047	B500395	SCREW 3.5X16	3		*
190033	B500418	SCREW TCEI UNC10-24X3/8" B18.3	4		
190049	B600018	WASHER PS 10x5x0,3	1		
190050	B600112	WASHER PS12X18X0.5 DIN988	2		
190052	B600159	CIRCLIP A12 DIN471	2		
190053	B600189	CIRCLIP RA3.2 DIN6799	5		
190054	B600190	CIRCLIP D8 7435	2		
190134	B600227	CUP WASHER CB12.5X6.2X0.7 D.2093			
190057	B600343	SPRING G13-025 ISO10243	1		
190059	B600345	CIRCLIP D34 UNI 7435	1		
190060	B600346	CIRCLIP D15 UNI7435 R150	1		
190061	B600376	WASHER PS 15X21X0.5	1		
190075	B600391	WASHER PS 6X21X0.2	1		
190062	B700076	PIN 4X12 DIN6325	1		
190063	B700101	PIN 6X28 DIN6325	1		
190143	B700103	ROLL PIN 3x10 UNI6873	1		
190064	B700325	SPHERE DIAM.5mm	8		
190065	B800364	ELECTRONIC POWER CARD	1		*
190066	B800366	KEYBOARD	1		*
190067	B800378	WELDING MICROSWITCH	1		*
190068	B800396	TENSION MICROSWITCH	1		*
190069	B800397	POWER CABLES KIT	1		
190070	D000010	PIN	1		
190071	D000170	GEAR SHAFT	1		
190072	D000200	FRONT STRAP GUIDE	1		
190073	D000250	STRAP LOCKER	1	§	*
190117	D000280	REAR STRAP GUIDE SPRING	1		

POLYCHEM PART NO.	ITEM	DESCRIPTION	QTY		
190074	D000330	FREEWHEEL SUPPORT	1		
190076	D000390	LOCKING COVER	1		
190077	D000400	GEAR	1		
190078	D000430	EPICICLOIDAL GEARBOX	1		
190079	D001140	TENSION SPRING	1		
190122	D001420	SPECIAL SCREW M4x10	1		
190080	D002010	WELDING FOOT	1	§	*
190081	D002020	WELDING FOOT PIN	1		
190082	D002030	FLANGE	1		
190083	D002040	CONNECTING ROD	1		
190084	D002050	ECCENTRIC SHAFT	1		
190085	D002060	SUPPORT	1		
190086	D002070	WELDING FOOT SUPPORT	1		
190087	D002080	SPRING SUPPORT	1		
190090	D002120	CUTTER	1	§	*
190091	D002130	CUTTER GUIDE	1		
190092	D002140	COVER	1		
190022	D002150	FEEDWHEEL SUPPORT ASSY.	1		
190023	D002160	MOTOR SUPPORT ASSY.	1		
190135	D002170	OPENING LEVER SUPPORT	1		
190093	D002180	SHAFT	1		
190094	D002190	HOOK	1		
190095	D002200	OPENING LEVER	1		
190096	D002220	WELDING MOTOR FLANGE	1		
X	D002230	WELDING CAM	1		
190098	D002240	SPRING PIN	1		
190099	D002250	SPRING SUPPORT	1		
190100	D002260	SUPPORT PIN	1		
X	D002270	ROLLER	1		
190102	D002280	CAM PIN	1		
190104	D002300	WELDING GROUP SPRING	1		*
190105	D002310	CUTTER SPRING	1		*
190107	D002330	FEEDWHEEL	1	§	*
190108	D002350	COVER	1		
190110	D002990	BATTERY RELEASE SPRING	1		
190155	D003100	BATTERY RELEASE LEVER	1		
190111	D003360	RIGHT COVER	1		
190112	D003370	LEFT COVER	1		
190113	D003380	KEYBOARD SUPPORT	1		
190114	D003390	TENSION BUTTON	1		
190115	D004270	TENSION BUTTON SPRING	1		*
190145	D004560	OPENING LEVER SPRING SCREW	1		
190159	D004580	WELDING PLATE	1	§	*
190138	D004660	REAR STRAP GUIDE	1		

	§	WEARING PART
	*	PART THAT SHOULD BE STOCKED

- LOCTITE 268
 ● LOCTITE 243
 ▲ SKF LIGHT 2
 X NON FORNIBILE SINGOLARMENTE
 NOT SUPPLIED ALONE

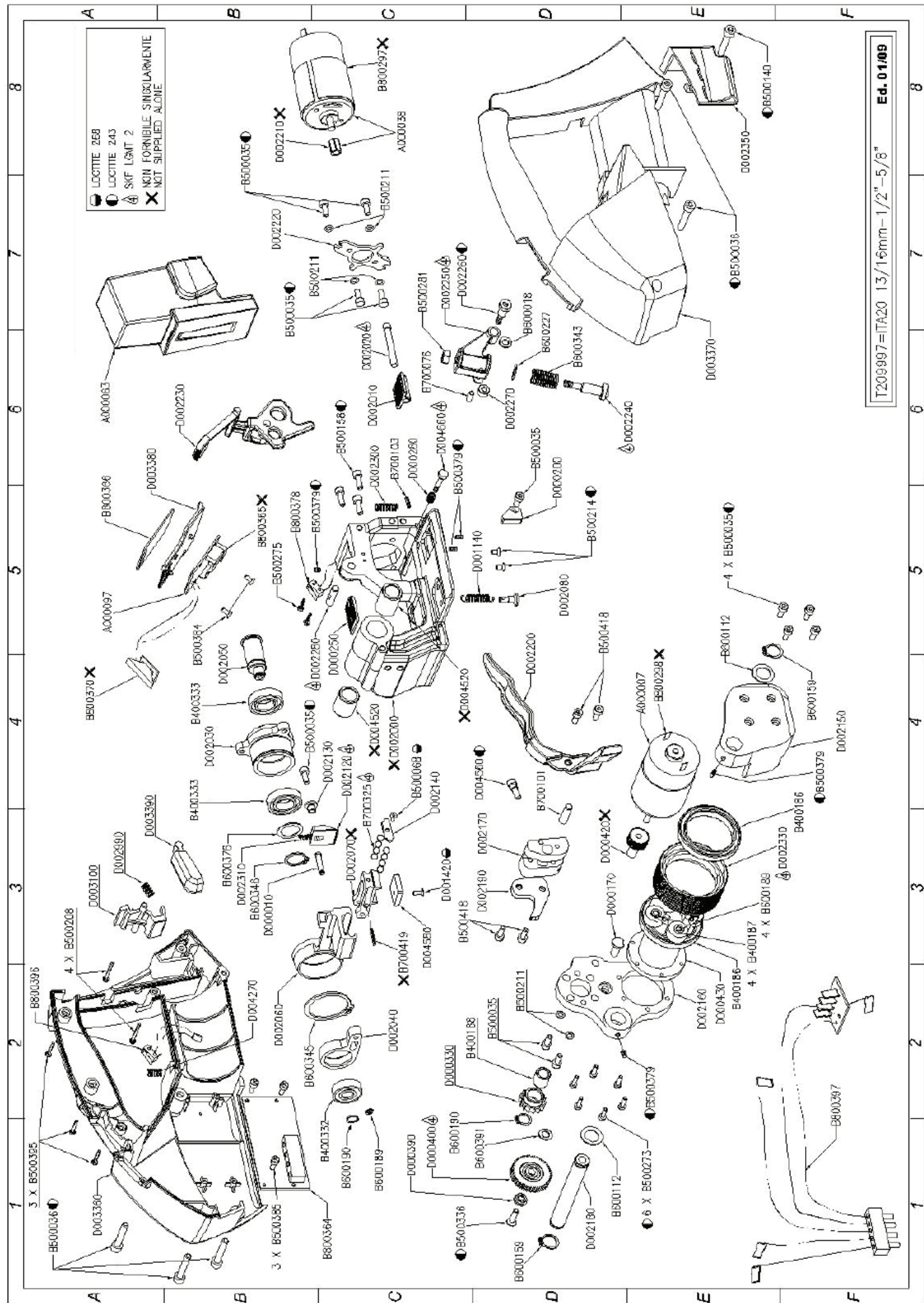

T209997=ITA20 13/16mm-1/2"-5/8" Ed. 01/09