

9) LAYOUT-SPARE PARTS LIST

Ed. 06/17

POLYCHEM PART #	ITEM	DESCRIPTION	QTY		
190120	A000006	HT TENSION MOTORGROUP	1		*
X	A000038	WELDING MOTORASSEMBLED	1		*
B800BAT	A000115	BATTERY 3A/h	1	§	*
X	A000097	SIGNAL CARD	1		*
190026	B400186	BEARING 61808-RS1	2		
190027	B400187	ROLLER BEARING 5X8X8	4		
190028	B400188	FREEWHEEL INAHF0812	1		
190029	B400332	BEARING 609 ZZ SKF	1		
190030	B400333	BEARING 61902 ZZ	2		
190031	B500035	SCREW M4X10	11		
190032	B500036	SCREW M5X12	5		
190161	B500068	SCREW M3X8 UNI 5931	1		
190036	B500140	SCREW M5X30	1		
190037	B500158	SCREW M4X12	3		
190038	B500208	SCREW BN13577 3,5X20 KA35	4		
190147	B500211	LOCK. WASHER	6		
190039	B500214	SCREW M4X8	2		
190040	B500273	SCREW M3X10	6		
190041	B500275	SCREW M2X10	2		
190042	B500281	SELFLOCK. NUT M6 D985 5S	1		
190043	B500336	SCREW M4X10	2		
190044	B500379	SCREW M4X5	5		
190045	B500384	SCREW 2.9X4.5	2		
190046	B500385	SCREW 2.9X6.5	3		
190047	B500395	SCREW 3.5X16	3		*
190033	B500418	SCREW TCEI UNC10-24X3/8" B18.3	4		
190049	B600018	WASHER PS 10x5x0,3	1		
190050	B600112	WASHER PS12X18X0.5 DIN988	2		
190052	B600159	CIRCLIP A12 DIN471	2		
190053	B600189	CIRCLIP RA3.2 DIN6799	5		
190054	B600190	CIRCLIP D8 7435	2		
190134	B600227	CUP WASHER CB12.5X6.2X0.7 D.2093	1		
190057	B600343	SPRING G13-025ISO10243	1		
190059	B600345	CIRCLIP D34 UNI 7435	1		
190060	B600346	CIRCLIP D15 UNI7435 R150	1		
190061	B600376	WASHER PS 15X21X0.5	1		
190075	B600391	WASHER PS 6X21X0.2	1		
190062	B700076	PIN 4X12 DIN6325	1		
190063	B700101	PIN 6X28 DIN6325	1		
190143	B700103	ELASTIC PIN 3x10UNI6873	1		
190064	B700325	SPHERE DIAM.5mm	8		
190066	B800366	KEYBOARD	1		*
190067	B800378	WELDING MICROSWITCH	1		*
190068	B800396	TENSION MICROSWITCH	1		*
190069	B800397	POWER CABLE KIT	1		
190121	B800424	ELECTRONIC POWERCARD	1		*
190070	D000010	PIN	1		
190071	D000170	GEAR SHAFT	1		

POLYCHEM PART #	ITEM	DESCRIPTION	QTY		
190073	D000250	STRAP LOCKER	1	§	*
190117	D000280	REAR STRAP GUIDESPRING	1		
190074	D000330	FREEWHEEL SUPPORT	1		
190076	D000390	LOCKING COVER	1		
190077	D000400	GEAR	1		
X	D000430	EPICICLOIDAL GEARBOX	1		
190079	D001140	TENSION SPRING	1		
190122	D001420	SPECIAL SCREWM4x10	1		
190081	D002020	WELDING FOOT PIN	1		
190082	D002030	FLANGE	1		
190083	D002040	CONNECTING ROD	1		
190084	D002050	ECCENTRIC SHAFT	1		
190087	D002080	SPRING SUPPORT	1		
190091	D002130	CUTTER GUIDE	1		
190092	D002140	COVER	1		
190022	D002150	FEEDWHEEL SUPPORTASSY.	1		
190135	D002170	LEVER SUPPORT	1		
190023	D002160	MOTOR FLANGE	1		
190093	D002180	SHAFT	1		
190094	D002190	HOOK	1		
190095	D002200	OPENING LEVER	1		
190096	D002220	WELDING MOTORFLANGE	1		
190097	D002230	WELDING CAM	1		
190098	D002240	SPRING PIN	1		
190099	D002250	SPRING SUPPORT	1		
190100	D002260	SUPPORT PIN	1		
190101	D002270	ROLLER	1		
190102	D002280	CAM PIN	1		
190104	D002300	WELDING GROUP SPRING	1		*
190110	D002990	BAT. RELEASE / CUTTER SPRING*	2		*
190111	D003360	RIGHT COVER	1		
190112	D003370	LEFT COVER	1		
190115	D004270	TENSION BUTTON SPRING	1		*
190123	D004540	WELDING FOOT	1	§	*
190163	D004550	TENSION MOTORPROTECTION	1		
190145	D004560	OPENING LEVER SPRING SCREW	1		
190124	D004600	WELDING PLATE	1	§	*
190125	D004610	FEEDWHEEL	1	§	*
190126	D004620	CUTTER	1	§	*
190136	D004630	FRONT STRAP GUIDE	1		
190158	D004640	SUPPORT	1		
190137	D004650	WELDING FOOT SUPPORT	1		
190138	D004660	REAR STRAP GUIDE	1		
190139	D004710	BATTERY RELEASE LEVER	1		
190140	D004720	TENSION BUTTON	1		
190141	D004730	KEYBOARD SUPPORT	1		
190142	D004740	BLADE COVER	1		
		§	WEARING PART		
		*	PART THAT SHOULD BE STOCKED		

B800

- LOCITTE 268
- LOCITTE 243
- ⚙ SKF LGMT 2
- ✘ NON FORNIBILE SINGOLARMENTE
NOT SUPPLIED ALONE

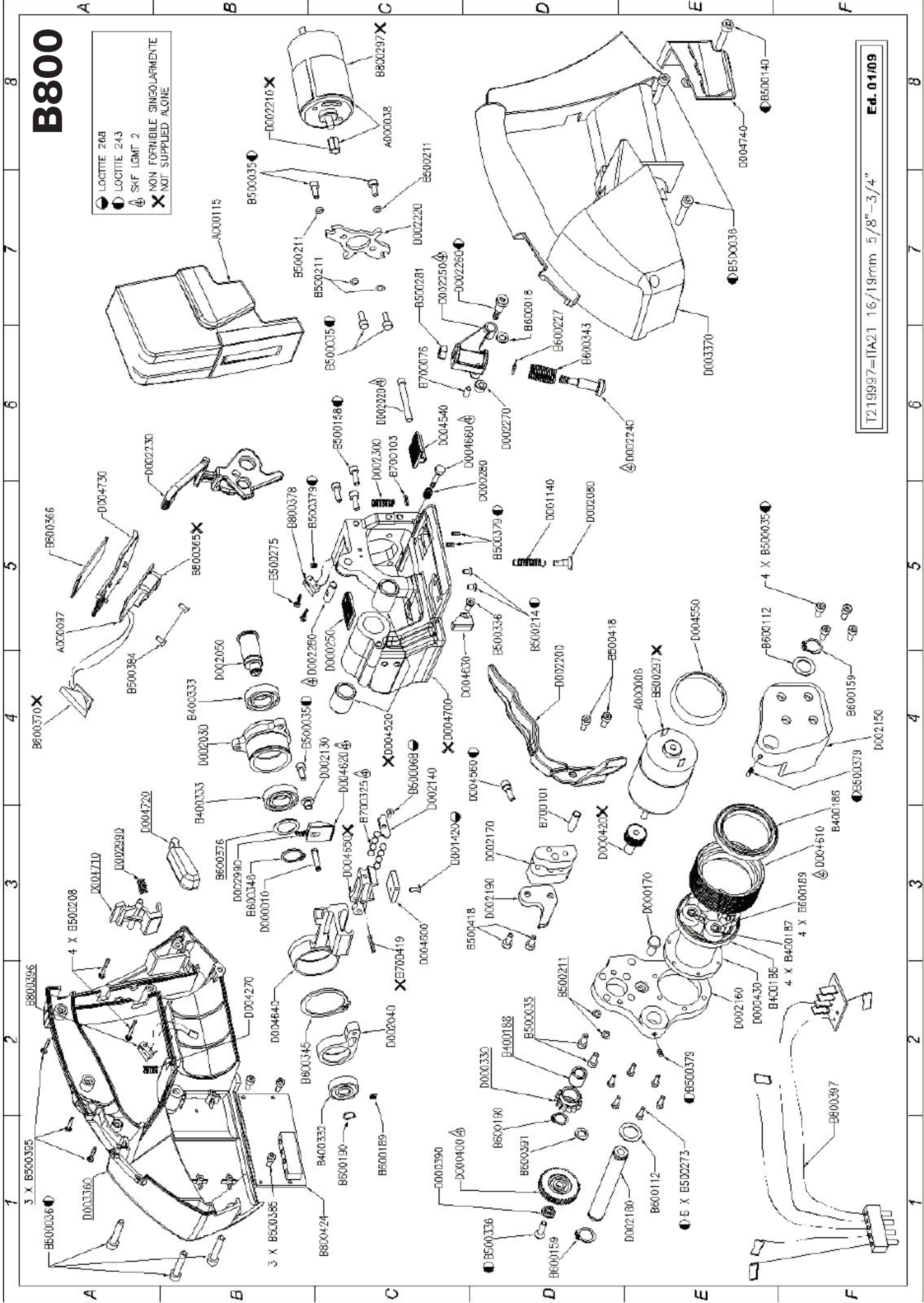

T21997=ITA21 16/19mm 5/8"-3/4"
Ed. 01/09