

PARTS LIST

| <u>KEY</u> | <u>QTY.</u> | <u>PART NO.</u> | <u>DESCRIPTION</u> |
|------------|-------------|-----------------|---------------------------------------|
| 1 | 1 | 424091 | Base |
| 2 | 1 | 424245 | Back guide |
| 3 | 1 | 424244 | Front guide |
| 4 | 3 | 010032 | SHCS M6x12 |
| 5 | 8 | 010077 | Lock washer M6 |
| 6 | 3 | 006045 | Roll pin 1/8 x 3/8 long |
| 7 | 2 | 424098 | Lifter |
| 8 | 1 | 424106 | Locking plate |
| 9 | 1 | 251331 | SHSS M6x12 |
| 10 | 1 | 424241 | Energizing spring |
| 11 | 8 | 274931 | Dowel pin 3 x 12 long |
| 12 | 2 | 259935 | SHCS M3 x 12 |
| 13 | 4 | 162568 | Lock washer M3 |
| <u>14</u> | <u>3</u> | <u>424300</u> | <u>Punch</u> |
| 15 | 2 | 262456 | SHCS M3 x 6 |
| 16 | 2 | 162383 | SHCS M4 x 8 |
| 17 | 1 | 424099 | Die support |
| <u>18</u> | <u>1</u> | <u>424094</u> | <u>Cutter</u> |
| <u>19</u> | <u>1</u> | <u>424107</u> | <u>Cutter anvil</u> |
| 20 | 1 | 424097 | Die holder |
| 21 | 1 | 424087 | Cam roller pin |
| 22 | 2 | 424117 | Washer |
| 23 | 1 | 424118 | Cam roller |
| 24 | 60 | 424301 | Needle roller |
| 25 | 1 | 424103 | Sealer cover |
| 26 | 1 | 424121 | Outer guide |
| 27 | 2 | 162391 | Dowel pin 5x24 |
| 28 | 5 | 010037 | SHCS M6x20 |
| 29 | 1 | 274047 | Dowel pin 6 x 16 |
| 30 | 1 | 424324 | Feedwheel cover assembly |
| 31 | 1 | 424308 | Garlock DU bushing 08DU08 1/2 x 1/2 |
| 32 | 1 | 424310 | Garlock DU bushing 09DU06 9 1/6 x 3/8 |
| 33 | 1 | 253433 | Dowel pin 4x14 |
| 34 | 1 | 424120 | Link |
| <u>35</u> | <u>1</u> | <u>424119</u> | <u>Clutch plug</u> |
| 36 | 1 | 002678 | O-Ring |
| <u>37</u> | <u>1</u> | <u>424240</u> | <u>Feedwheel</u> |
| 38 | 1 | 424309 | Feedwheel spacer |
| 40 | 1 | 424083 | Feedwheel support |
| 41 | 1 | 424248 | Feedwheel shaft |
| 42 | 1 | 424247 | Holding pawl pin |
| 43 | 1 | 424249 | Pivot pin |
| 44 | 1 | 424307 | Garlock DU bushing 06DU04 3/8 x 1/4 |
| 45 | 1 | 003454 | Long retaining pawl |
| 46 | 1 | 003455 | Short retaining pawl |
| 47 | 2 | 003483 | Retaining pawl spring |
| 48 | 1 | 005054 | Retaining ring, Truarc 5100-31 |
| 49 | 1 | 424317 | Tension handle assembly |
| 50 | 1 | 003462 | Handel pawl |

| <u>KEY</u> | <u>QTY.</u> | <u>PART NO.</u> | <u>DESCRIPTION</u> |
|------------|-------------|-----------------|--------------------------------|
| 51 | 1 | 424246 | Handle pawl pin |
| 52 | 1 | 003467 | Pawl spring |
| 53 | 1 | 424108 | Ratchet |
| 54 | 1 | 424319 | Cam/Handle assy (Note-3) |
| 55 | 1 | 010054 | Knob (Note-3) |
| 56 | 1 | 010057 | Roll pin 1/4 x 1/ 3/4 (Note-3) |
| 57 | 2 | 424303 | Cam spacer (Note-3) |
| 58 | 2 | 422831 | Dowel pin, 4 x 10 (Note-3) |
| 59 | 1 | 424079 | Eccentric shaft |
| 60 | 1 | 274385 | Dowel pin 6 x 20 |
| 61 | 1 | 252247 | Dowel pin |
| 65 | 1 | 424311 | Warning sign |
| 66 | 1 | 424312 | Nameplate, 1/2 |
| | 1 | 424314 | Nameplate, 5/8 |
| | 1 | 424316 | Nameplate, 3/4 |
| 67 | 1 | 286374 | Safety sign |
| 68 | 1 | 424321 | Deflector (Note-6) |

- When ordering parts, please show model, part number and description.
- Standard hardware parts may be obtained at any local hardware supply.
- Recommended spare parts are underlined and should be stocked.

NOTES:

1. Locking Plate (Key 8) must be installed with the text "OUT" facing away from base.
2. Outer Guide (Key 26) must be installed with chamfer side out.
3. Key numbers 54 through 58 and Key 24 can be purchased as Part No. 424313.
4. Socket head cap screws (Key 28) which secure the Sealer Cover (Key 25) must be torqued to 85-95 in-lbs.
5. Lubricate all moving parts with Molith No. 2 or Lubriplate 3000W Grease, GR-132 (Signode Part No. 422793).
6. The Deflector (Key 68) is an optional part which is used to prevent the strap from curling around the feedwheel from severe high tension applications.
7. Key numbers 30, 31, 32, 33, and 60 can be purchased together as Signode Part No. 424323.

⚠ WARNING

Inspect all parts daily and replace them if they are worn or broken. Failure to do this can affect a product's operation and could result in serious personal injury.

* Use Loctite #242 (Signode Part No. 422795) or equivalent.

** Use Loctite #222 (Signode Part No. 422794) or equivalent.

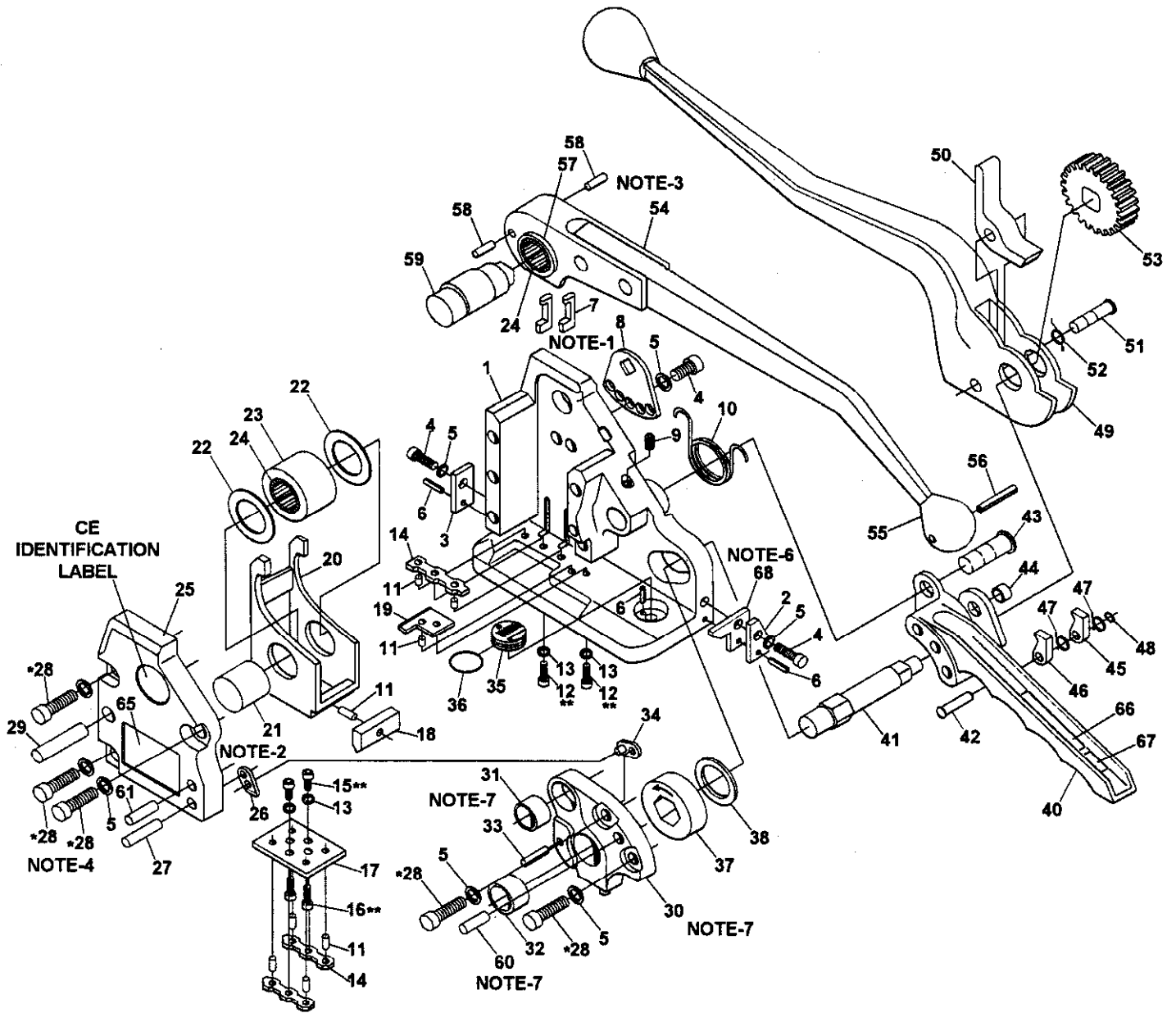

Review page 11 of this manual for explanation of notes.